

**BERNINA**  
Embroidery  
Software 7

# In-the-Hoop Card Holder

Create a fun in-the-hoop card holder to keep track of business, membership, or discount cards.

Just pull the ribbon  
and the cards pop up!

Try your hand at embroidery on leather or **Kraft Tex**.

Reduce design density or change the types of embroidery stitching used so specialty materials do not become over-perforated.

Reference the companion project instructions for stitch-out details.

## Create a Lightweight Design Fill

- ◆ Access the lesson designs included with these instructions:  
**Card\_Holder\_Blank.ART70** and **Card\_Holder\_Sample.ART70**.
  - ◆ Remove the designs from inside the .zip folder.
  - ◆ Select **File > Open** and navigate on your computer to the location of the designs.
  - ◆ Select **Card\_Holder\_Blank.ART70** and **Open**.
  - ◆ With the design selected from the upper dropdown menu select **Arrange>Ungroup**.
  - ◆ Right click on the **Show Hoop** icon and select the **Large Oval Hoop, #26**.
  - ◆ Place a checkmark in **Show Hoop** and click <OK>.
  - ◆ Click the **Art Canvas** icon and in the **Units of Measure** dialog select **Inches**.
  - ◆ Select the **Lettering** icon and click in the workspace to get a blinking cursor.
  - ◆ Type the word "CARDS" and click the **Select** icon.
  - ◆ Use the dropdown **Font List** to select the font of your choice.  
(*Berlin Sans FB Demi* was used for the Sample. It can be downloaded from the ufonts.com website: <http://ufonts.com/download/berlin-sans-fb-demi-bold/100640.html> )
  - ◆ For information on installing fonts in Windows please visit:  
<http://windows.microsoft.com/en-us/windows-vista/install-or-uninstall-fonts>
  - ◆ Check that the **Lock Ratio** is not clicked down and in the **Object Size** dialog type:  
**3" for Width** and **1½" for Height**.
  - ◆ **RIGHT** Click on the selected lettering to open the Context Menu.
  - ◆ Select **Convert to Curves**. Click on **Convert Artwork to Embroidery**.
  - ◆ Click the **Object Properties** icon. In the **Fill Stitch** tab change the **Stitch spacing**:  
to **2 mm** and **Apply**. This will greatly reduce the perforations to the Kraft Tex or leather.
  - ◆ Select the **Stitch Angle** tab and type **180°** and **Apply**. Click on <Effects...>
  - ◆ Remove the checkmark for **Underlay 1** and **Apply**. Click on the **Others** tab.
  - ◆ Place a checkmark in **Travel on Edges** and <OK> to apply and close the dialog box.
  - ◆ Open the **Edit Toolbox** and click the **Outline Design** icon.
  - ◆ For **Color: 0020** Isacord 40, **Offset: 0**, **Outline Count: 1**, checkmark in **Outline Holes**,  
**Outline type: Triple** and click <OK> .
  - ◆ Hold the <Ctrl> key and select both the lettering and the outline from the **Color Film**.
  - ◆ With both selected from the upper dropdown menu select **Arrange>Group**.
- This adjustment to the fill created a lightweight design perfect for stitching on materials

Reference the companion project instructions for stitch-out details.

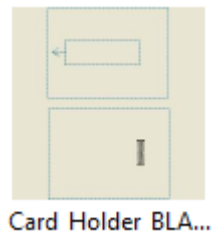

### HINTS

#### Inserting and editing text

- To insert text at the insertion point, type.
- To set an insertion point, point the cursor to it, and then click.
- To select text, drag across it.
- To change the font of selected text, choose a new font from the Font list box on the property bar.
- To move through text, click inside it, and then use the Arrow keys or the mouse.
- To change the spacing of selected text, click the Shape tool.

You can also adjust paragraph text frames (see "Adjusting paragraph text frames") and fit text to a path (see "Fitting text to a path"). See "Adding text" for basic information on working with text.

Fill type: Step

Stitch settings

Stitch spacing: 2.00 mm

Stitch length: 4.00 mm

☐ Underlay 1

Underlay type: ☒ Travel on edges

Stitch length:

Outline Design

Color: 0020 Isacord 40

Offset: 0.00 in

Outline count: 1

☒ Outline holes

Outline type: ☒ Triple

☐ Single

☐ Satin

OK Cancel

that are subject to over-perforation such as: paper, leather, Kraft Tex, metal etc...  
These Fill Settings can be saved for later use in Fabric Type settings or as a Template.  
*Watch the webcast video for more information on the benefits Fabric Type selections.*

- ◆ From the upper menu select *Settings>Manage Fabrics* and click *Create...*
- ◆ Type *Open Fill* and <OK> In the *Step Fill* tab change the *Stitch Spacing* to **2mm**.
- ◆ Change the *Underlay type* to *Edge Walk*. Click the *Stabilizer* tab.
- ◆ Type *StabilStitch Tear Away* and click <OK> and <Close>.
- ◆ From the upper menu select *Design>Fabric*. Use the *Fabric Type*: dropdown to select the newly created *Open Fill* fabric type and click <OK>.
- ◆ Move the lettering into the upper 3"x4" box and position over the smaller rectangle.
- ◆ Hold the <Ctrl> key and select the upper 3"x4" box and the lettering.
- ◆ Open the *Arrange Toolbox* and select *Align Centers*.



## Adjust the Density of an Existing Embroidery Design

- ◆ Select the *Insert Embroidery* icon. Navigate to C: My Designs-Embroidery Software 7 > Susanne Mueller > BE1009004.ART70 and <Open>.
- ◆ With the design selected from the upper dropdown menu select *Arrange>Ungroup*  
*The design comes in with reduced density fills, but the satin stitching - even if the density was reduced - would over-perforate the material.*
- ◆ Select the Black satin stitching of the crown (the last object of the Color Film.).
- ◆ Click on the Triple Stitching icon in the lower Outline menu.
- ◆ Select and **RIGHT** click the Black outlines of the crown in the *Color Film*.
- ◆ Click *Hide* from the context menu. This will temporarily hide the stitching.
- ◆ Activate the Show Objects icon at the top of the Color Film (On = Orange)
- ◆ Select and delete the additional red outline so only the fill area remains.
- ◆ Select the fill area and click on the Object Properties icon. Click <Effects...>.
- ◆ In the *Others* tab put a checkmark in the *Travel on edges*. Click <Apply>.
- ◆ Click the Underlay tab and remove the checkmark from Underlay 1 and <Apply>.
- ◆ Select the green area of fill from the Color Film.
- ◆ Remove the checkmark from Underlay 1 and <Apply> .
- ◆ Select the *Others* tab and put a checkmark in the *Travel on edges*. Click <OK>.
- ◆ Select and **RIGHT** click the Black outlines of the crown in the *Color Film*.
- ◆ Click *Unhide All* from the context menu. This stitching will become visible.
- ◆ Press the letter <T> on the keyboard to activate *Design View*.
- ◆ Click the Zoom icon and drag a bounding box around the crown for a close up view.
- ◆ Select and delete areas of unwanted stitching (selected area is pink in Design View.)
- ◆ Click the *Undo* icon to replace a deleted piece of the design.

*Watch the webcast video for more detailed instructions on stitch editing.*

- ◆ Select the *Reshape Object* icon and select the curved lines at the top of the crown.
- ◆ Select and Delete the endpoint of the line. Repeat for the opposite side.
- ◆ Press the letter <T> on the keyboard to return to *Artistic View*.
- ◆ Reshape the line along the top of the red fill area to close the gap.
- ◆ Click the Select icon. Removing stitch areas of the design has created jumps.
- ◆ Select the Black outlines of the crown from the *Color Film*.
- ◆ Open the Edit Toolbox and select the Blackwork Run icon.
- ◆ Press <Enter> on the keyboard and all jump stitching is removed.
- ◆ Draw a bounding box around the crown to select it and *Arrange>Group*.
- ◆ Press <0> on the keyboard to *Zoom All*. Click the *Rotate Right* icon twice.
- ◆ Move the crown into the lower 3"x4" box below the buttonhole.
- ◆ Hold the <Ctrl> key and select the outer box and the crown.
- ◆ Open the *Arrange Toolbox* and select the *Align Centers* icon.
- ◆ From the upper menu select *Edit > Select All* then *Arrange > Ungroup*.
- ◆ Using the *Color Film* change all the black design elements to the same color of Black.
- ◆ *Edit > Select All* and click the *Sequence by Color* icon at the top of the *Color Film*.
- ◆ Select the Black color group and click <Move Down> to move them to the bottom.
- ◆ Click <OK> to accept the sequence. From the upper menu select *File > Save As*.



# CARDS

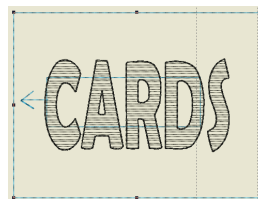

BE1009004.ART70



Triple Outline / Settings

Create a thicker outline by repeating each stitch three times - use for heavier borders or details. Right-click for settings.

Press <F1> for more help

Color Film

Show Objects  
View individual objects in order of stitching sequence. Drag and drop object icons to resequence.

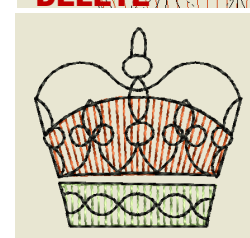
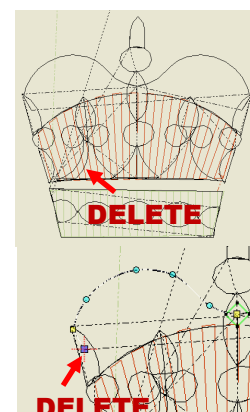
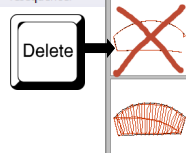

Finished Crown