

## Manual and installation instructions

Echo-quilting clips 102959.70.00

### Information

- 1x Echo-quilting clip, Radius 0.5 Inch
- 1x Echo-quilting clip, Radius 0.75 Inch
- 1x Echo-quilting clip, Radius 1.0 Inch

### Application

The Echoquilt-clips are suitable for quilting. They to be used with the adjustable Ruler foot #72 or the Ruler foot #96.

### For your safety

Before using the accessory please read the instruction manual of the machine and the accessory carefully!

### Operation

#### Attachment

- Place the clip with the marking lines pointing downwards on a stable base (1)
- Carefully push in the foot from above (2 + 3)

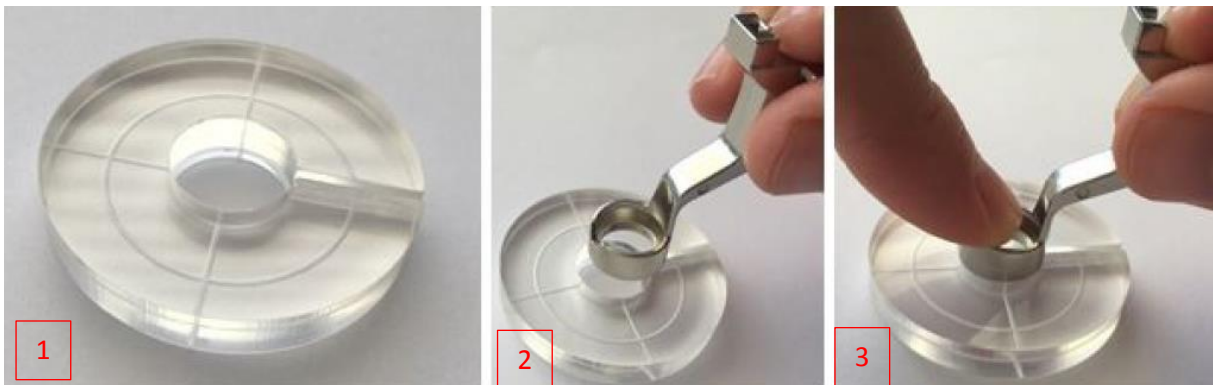

#### Removing

- Remove the foot from the machine (4)



### Important:

The clip must **never** be removed if the foot is still mounted on the machine! There is a risk of the foot bending or even breaking.

- Remove the clip by hand (variant 1) or with the aid of a tool (variant 2)

### Variant 1 – By hand

- Hold the foot with one hand (5)
- Use your free hand to release the clip from the foot with a twisting movement downwards (6 + 7)



### Variant 2 – With the aid of a tool

- Hold the clip on a stable base (8)
- Carefully insert the blunt, flat object (e. g. screwdriver) into the opening of the clip (9)
- Remove clip from foot (10)

